

# Construction Options

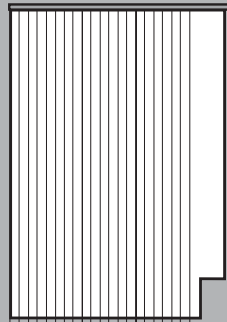

23|21|19|17|15|13|11|9|7|5|  
24" 22 20 18 16 14 12 10 8 6 4"

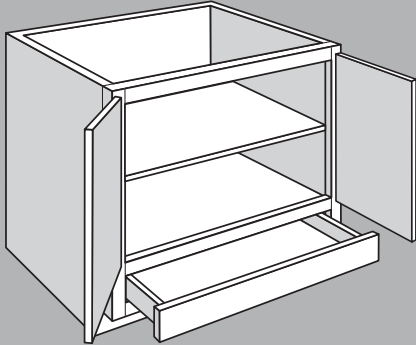
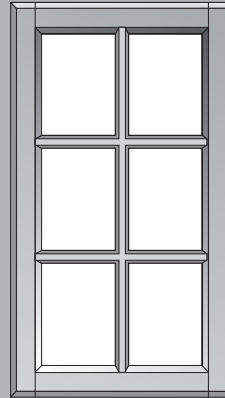
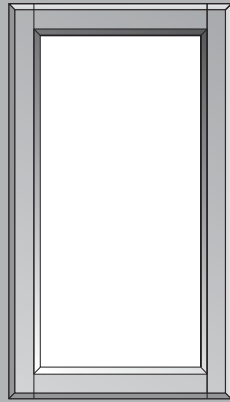
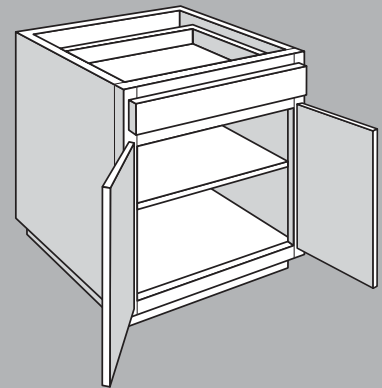

CONSTRUCTION OPTIONS	CODE
All Plywood Construction Option	APC
Cabinet Front Only Option	CFO
CushionClose® Package	(Pre-selected in 20-20)
Furniture Ends Option	FE
Increased Depth Option	ID
Inverted Frame Option	IF
Matching Interior Option	MI
Plywood Ends Option	PE
Premium Finish Options	Painted Boulder Painted Ember Glaze Painted Harbor Painted Hazelnut Glaze Painted Linen Painted Navy Painted Pewter Glaze Painted Sage Painted Silk Painted Stone
Recessed Toe Kick Option	RTKL (Recessed Toe Kick Left) RTKR (Recessed Toe Kick Right) RTKB (Recessed Toe Kick Both)
Reduced Depth Option	RD
Void Door Option - NO Molding	VDO-DFH (Drilled For Hinges)
Void Door Options - INCLUDING Molding	VDO-SAM (Shaker Accent Molding) VDO-SBAM (Single Bead Accent Molding)
Void Top Drawer Option	VTD
Remove CushionClose for Doors	XCDO
Remove CushionClose for Drawers	XCDW
Remove CushionClose for Roll Out Accessories	XCRO

SPECIALTY DOOR (SD) OPTIONS	CODE
Aluminum Frame Door - Brushed Aluminum	AFBA
Mullion Frame Door	MFD
Open Frame Door	OFD

1. When the option appears, it indicates the construction option is available for all SKU's in the product box unless otherwise noted.

In this product box, all SKUs (B36, B39, B42 and B48) are available with All Plywood Construction, Cabinet Front Only, Furniture Ends, Inverted Frame, Plywood Ends, Reduced Depth and Recessed Toe Kick options.

Base Cabinet 2 Doors, 2 Drawers	
B36	APC
B39	CFO
B42	FE
B48	IF
	PE
	RD
	RTK

2. When a square ■ is included within the icon and next to the SKU, it indicates the construction option is ONLY available for that specific SKU.

In this product box, only the W930, W1230, W1530, W1830, W2130 and W2430 are available with the Void Door or Matching Interior Options as the Specialty Door (SD) cabinets feature Matching Interior standard.

Wall Cabinet 30" High, 1 Door	
■ W930	APC
■ W1230	CFO
■ W1530	FE
■ W1830	ID
■ W2130	■ MI
■ W2430	PE
	RD
	■ VDO
W1230 SD	
W1530 SD	
W1830 SD	
W2130 SD	

3. When a construction icon is not listed, it indicates the construction option is NOT available for any SKU in the product box.

In this product box, none of the SKUs are available with Matching Interior, Void Door or Void Top Drawer Options as these icons are not listed.

Base Cabinet 1 Door, 1 Drawer	
B12	APC
B15	CFO
B18	FE
B21	IF
B24	PE
	RD
	RTK

## All Plywood Construction Option

**APC**

All Plywood Construction Option includes:

- ½" plywood sides, floors and cabinet tops
- ¾" plywood shelves with edge banding
- ⅝" plywood captured back
- ½" plywood inset toe kick
- ½" plywood corner blocks (excluding BEA/BER/BPP/BPPUS/BTDP/CAR cabinets)

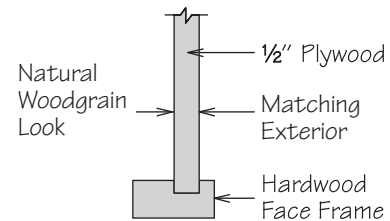

### Notes:

- Exterior sides finished to match specific cabinet box exterior.
- Plywood will be visible from top and bottom of side panels.
- Available for individual cabinets or entire kitchen.
- Available for all door styles.
- All door styles feature standard interior sides with a natural woodgrain look and matching exterior sides.
- **Cannot be ordered with Plywood Ends Option.**
- Available with Matching Interior Option. Please refer to the product SKU box for details .
- Toe kick support blocks are not plywood.
- Roll out accessories and drawer inserts will not feature All Plywood Construction.
- All Plywood Construction refers to the cabinet box components and shelving as detailed above (certain parts and accessories are not available with this construction option).
- Plywood can consist of a combination of veneer and medium density fiberboard (MDF) layers to achieve superior product stability and finish quality. Plywood components meet the ANSI/Decorative Hardwoods Association hardwood and decorative plywood standards ([www.decorativehardwoods.org](http://www.decorativehardwoods.org)).

## Plywood Ends Option

**PE**

Plywood Ends Option includes:

- ½" plywood cabinet sides

### Notes:

- Exterior sides finished to match cabinet box exterior.
- Plywood will be visible from top and bottom of side panels.
- Available for individual cabinets or entire kitchen.
- All door styles feature standard interior sides with a natural woodgrain look and matching exterior sides.
- **Cannot be ordered with All Plywood Construction Option or Furniture Ends Option.**
- Available with Matching Interior Option. Please refer to the product SKU box for details .
- Plywood Ends refers to the cabinet box side panels as detailed above (certain parts and accessories are not available with this construction option).
- Plywood can consist of a combination of veneer and medium density fiberboard (MDF) layers to achieve superior product stability and finish quality. Plywood components meet the ANSI/Decorative Hardwoods Association hardwood and decorative plywood standards ([www.decorativehardwoods.org](http://www.decorativehardwoods.org)).

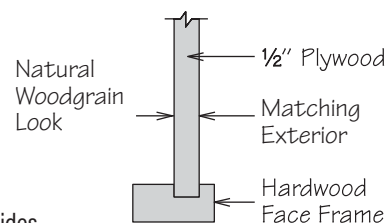

## Cabinet Front Only Option

**CFO**

The Cabinet Front Only Option is available for most cabinets with a frame (see individual cabinet specifications for  icon verifying this option availability).

### Notes:

- This option consists of the cabinet front face frame, door(s), drawer front(s) and hinges.
- Toe kicks are not included.
- This option is only available for cabinets without accessories.

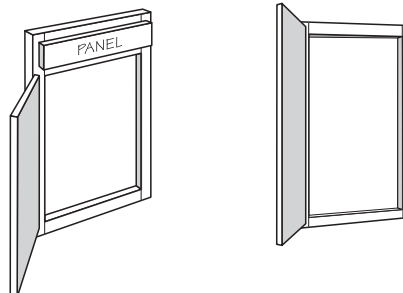

	Standard Construction	Plywood Ends Option (PE)	All Plywood Construction Option (APC)
<b>Cabinet Sides</b>	½" Engineered Wood	½" Plywood	½" Plywood
<b>Cabinet Floor</b>	½" Engineered Wood	½" Engineered Wood	½" Plywood
<b>Cabinet Top (Wall Cabinets Only)</b>	½" Engineered Wood	½" Engineered Wood	½" Plywood
<b>Cabinet Back</b>	⅙" Hardboard Substrate captured	⅙" Hardboard Substrate captured	⅙" Plywood captured
<b>Face Frame</b>	¾" x 1½" Hardwood	¾" x 1½" Hardwood	¾" x 1½" Hardwood
<b>Inset Toe Kick</b>	½" Engineered Wood	½" Engineered Wood	½" Plywood
<b>Corner Blocks (excluding CBS/CSB cabinets)</b>	½" Engineered Wood	½" Engineered Wood	½" Plywood
<b>Shelves</b>	¾" Engineered Wood with Edge Banding	¾" Engineered Wood with Edge Banding	¾" Plywood with Edge Banding
<b>Wall Cabinet Hanging Rails</b>	½" Engineered Wood Top and Bottom Rails	½" Engineered Wood Top and Bottom Rails	½" Plywood Top and Bottom Rails
<b>Base Cabinet Hanging Rails</b>	¾" Hardwood Top Rail ½" Engineered Wood Bottom Rail	¾" Hardwood Top Rail ½" Engineered Wood Bottom Rail	¾" Hardwood Top Rail ½" Plywood Bottom Rail

## Inverted Frame Option

IF

The Inverted Frame Option is available for most Standard Base Cabinets, Base Cabinets with Factory Installed Wastebasket(s) and Base Pot & Pan Organizer Cabinets (see individual cabinet specifications for  icon verifying this option availability).

### Notes:

- Drawer(s) below full cabinet floor.
- Available with All Plywood Construction (APC), Furniture Ends (FE), Plywood Ends (PE), Reduced Depth (RD) and Recessed Toe Kick (RTK) options.
- Back is not predrilled for Deep Roll Out Trays (DROT's).

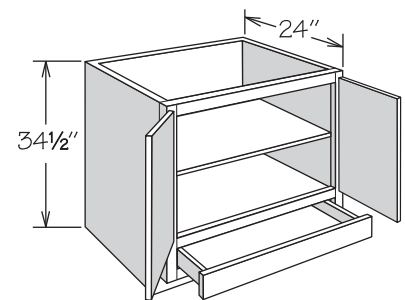
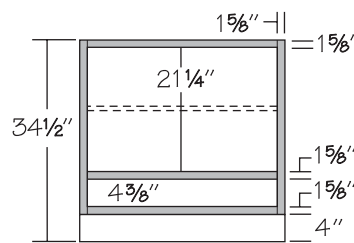

## Void Top Drawer Option

**VTD**

The Void Top Drawer Option is available for most 3 Drawer Base, 4 Drawer Base, Base with Deep Roll Out Trays, Base with Pot & Pan Organizer and Peninsula Base cabinets (see individual cabinet specifications for  icon verifying this option availability).

### Notes:

- This option removes the drawer body and glide system and replaces it with a false panel on any top drawer(s).
- On cabinets with multiple top drawers, all top drawers will be voided.
- When used with a drop-in appliance, there is a height clearance of 7 5/8" from the top of the cabinet to the top of the door/drawer opening below the voided drawer
- Subtract 1 1/2" from width and depth for available top opening - removal of corner blocks may be required.
- Removal of the top rail is not recommended.
- Refer to appliance manufacturer's specifications for adequate clearances and required installation materials.

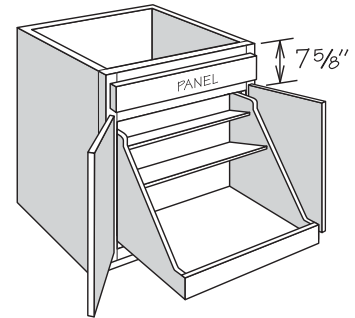
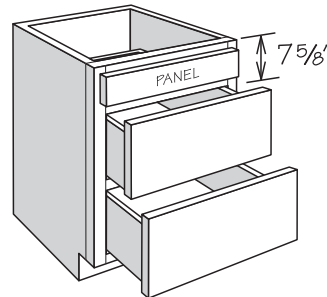

## Void Door Option

**VDO**

The Void Door Option is available for most wall cabinets. All void door cabinets ship without doors or hinges – center stiles and adjustable shelves will remain. Cabinet frames are pre-drilled for door hinges. All void door wall top hinge cabinets ship without door, lid stays and hinges.

Refer to the descriptions below to select the correct option for your layout:

- VDO-DFH (Drilled For Hinges)
- VDO-SBAM (Single Bead Accent Molding)
- VDO-SAM (Shaker Accent Molding)

### Notes for VDO with Molding:

- Can be used to create decorative open cabinets
- Decorative Accent Moldings will conceal hinge holes
- Molding is to be cut and field installed at the job site
- When matching interior is desired, the Matching Interior Option must be selected

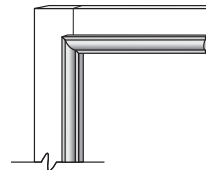

**VDO-SBAM**  
Single Bead Accent  
Molding

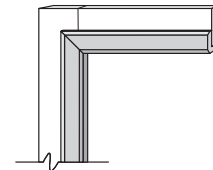

**VDO-SAM**  
Shaker Accent  
Molding

## Premium Finish Option

Our premium finishes accentuate the detailing and textures of the cabinetry.

- Luxurious paint which emphasizes lines and details with superior durability and consistent coverage.
- Glazes that settle into the recesses, corners and grooves to add definition and a distinctive patina.
- Glazes are applied over either a wood stain or painted base.

Premium Finish	Base Finish Details	Glaze Details	Available Collections
<b>Painted Ember Glaze</b>	Painted Harbor	Warm Brown Gray	Dominion, Edgeworth, Edgeworth w/ DFO, <a href="#">Glasson</a> , <a href="#">Glasson w/ DFO</a> , <a href="#">Irvington</a> , Irvington w/ DFO, McKinley, Stemson, Warren and Warren w/ DFO
<b>Painted Hazelnut Glaze</b>	Painted Silk	Deep Brown	Dominion, Edgeworth, Edgeworth w/ DFO, <a href="#">Irvington</a> , Irvington w/ DFO, McKinley, Stemson, Warren and Warren w/ DFO
<b>Painted Pewter Glaze</b>	Painted Linen	Dark Gray	Dominion, Edgeworth, Edgeworth w/ DFO, <a href="#">Glasson</a> , <a href="#">Glasson w/ DFO</a> , <a href="#">Irvington</a> , Irvington w/ DFO, McKinley, Stemson, Warren and Warren w/ DFO

Premium Finish	Finish Details	Available Collections
<b>Painted Boulder</b>	Dark Gray Paint	Breckenridge, Breckenridge w/ DFO, Cottage, Dominion, Edgeworth, Edgeworth w/ DFO, <a href="#">Glasson</a> , <a href="#">Glasson w/ DFO</a> , <a href="#">Irvington</a> , Irvington w/ DFO, McKinley, Mission, Mission w/ DFO, Stemson, Warren and Warren w/ DFO
<b>Painted Harbor</b>	Soft Warm Gray Paint	Breckenridge, Breckenridge w/ DFO, Cottage, Dominion, Edgeworth, Edgeworth w/ DFO, <a href="#">Glasson</a> , <a href="#">Glasson w/ DFO</a> , <a href="#">Irvington</a> , Irvington w/ DFO, McKinley, Mission, Mission w/ DFO, Stemson, Warren and Warren w/ DFO
<b>Painted Linen</b>	Soft White Paint	Breckenridge, Breckenridge w/ DFO, Cottage, Dominion, Edgeworth, Edgeworth w/ DFO, <a href="#">Glasson</a> , <a href="#">Glasson w/ DFO</a> , <a href="#">Irvington</a> , Irvington w/ DFO, McKinley, Mission, Mission w/ DFO, Stemson, Warren and Warren w/ DFO
<b>Painted Navy</b>	Dark Blue Paint	Breckenridge, Breckenridge w/ DFO, <a href="#">Cottage</a> , Dominion, Edgeworth, Edgeworth w/ DFO, <a href="#">Glasson</a> , <a href="#">Glasson w/ DFO</a> , <a href="#">Irvington</a> , Irvington w/ DFO, McKinley, Mission, Mission w/ DFO, Stemson, Warren and Warren w/ DFO
<b>Painted Sage</b>	Cool Dark Green Paint	Breckenridge, Breckenridge w/ DFO, Cottage, Dominion, Edgeworth, Edgeworth w/ DFO, <a href="#">Glasson</a> , <a href="#">Glasson w/ DFO</a> , <a href="#">Irvington</a> , Irvington w/ DFO, McKinley, Mission, Mission w/ DFO, Stemson, Warren and Warren w/ DFO
<b>Painted Silk</b>	Soft Cream Paint	Breckenridge, Breckenridge w/ DFO, Cottage, Dominion, Edgeworth, Edgeworth w/ DFO, <a href="#">Irvington</a> , Irvington w/ DFO, McKinley, Mission, Mission w/ DFO, Stemson, Warren and Warren w/ DFO
<b>Painted Stone</b>	Medium Cool Gray Paint	Breckenridge, Breckenridge w/ DFO, Cottage, Dominion, Edgeworth, Edgeworth w/ DFO, <a href="#">Glasson</a> , <a href="#">Glasson w/ DFO</a> , <a href="#">Irvington</a> , Irvington w/ DFO, McKinley, Mission, Mission w/ DFO, Stemson, Warren and Warren w/ DFO

## Reduced Depth Option

**RD**

The Reduced Depth Option should be used when ordering less than standard depth cabinets. The Reduced Depth Option is available in 1" increments; minimum depth is 4". Vanity and Desk cabinets will reduce to standard Reduced Depth increments (i.e. Vanity cabinets with RD-20 will measure 20" in depth).

Orders specifying Reduced Depth Option must show the total cabinet depth.

Example: Cabinet: B24  
Option: RD-17 (Reduce to 17" Deep)

**Notes:**

- There is a potential tipping hazard for Reduced Depth Cabinets until they are mounted to a wall.
- Peninsula Base cabinets reduced to 11" or less will not have an inset toe kick.
- Adjustable shelves are reduced in 1" increments to match Reduced Depth Option selected on cabinet(s).
- Adding the Reduced Depth Option does not remove adjustable shelves (where applicable).
- All cabinets reduced to 5" or less will not have an inset toe kick.
- Universal Design cabinets reduced to 9" or less will not have an inset toe kick.
- All cabinets reduced to 8" or less are not available with the Recessed Toe Kick Option.
- Universal Design cabinets reduced to 11" or less are not available with the Recessed Toe Kick Option.
- Reduced depth restrictions:
  - 24" Deep Wall Top Hinge cabinets are only available with RD-23 through RD-8.
  - 12" Deep Wall Top Hinge cabinets are only available with RD-11 through RD-8.
  - Base End Angle (BEA12 FH) cabinets are only available with RD-23 through RD-18.
  - Knee-hole Drawer cabinets are only available with RD-20 through RD-12.
  - Two Drawer Base cabinets are only available with RD-23 through RD-21.
  - 24" Deep Furniture Drawer cabinets are only available with RD-23 through RD-13.

Reduced Depth	Drawer Depth Base & 24" Deep Desk Cabinets	Drawer Depth Vanity & 21" Deep Desk Cabinets	Deep Roll Out Tray Depth
RD-23	18"	—	18"
RD-22	18"	—	18"
RD-21	18"	—	18"
RD-20	15"	15"	15"
RD-19	15"	15"	15"
RD-18	15"	15"	15"
RD-17	12"	12"	12"
RD-16	12"	12"	12"
RD-15	12"	12"	12"
RD-14	9 <sup>7</sup> / <sub>16</sub> "	9 <sup>7</sup> / <sub>16</sub> "	9"
RD-13	9 <sup>7</sup> / <sub>16</sub> "	9 <sup>7</sup> / <sub>16</sub> "	9"
RD-12	9 <sup>7</sup> / <sub>16</sub> "	9 <sup>7</sup> / <sub>16</sub> "	9"
RD-11 to RD-4	No Drawer	No Drawer	Not Available



## Increased Depth Option

ID

The Increased Depth Option is available for most Wall cabinets up to 36" wide and all Bookshelves (refer to individual cabinet specifications for  icon verifying this option availability). The Increased Depth Option is available in 1" increments; maximum depth is 24".

Orders specifying Increased Depth Option must show the total cabinet depth.

Example: Cabinet: W1530  
Option: ID-14 (Increase to 14" Deep)

### Notes:

#### Wall Cabinets:

- Adjustable shelves are increased in 1" increments to match Increased Depth Option selected on cabinets.
- Wall cabinets increased to more than 18" deep must be stacked, floor mounted or installed over a refrigerator.
- All Increased Depth cabinets must be securely attached in one of the following combinations: to studs in back wall and both sides (e.g., two adjacent cabinets or one adjacent cabinet and a wall) OR to studs in back wall, one side and top.

#### Peninsula Wall (PW) and Blind Peninsula Wall (BLPW) Cabinets:

- Increased Depth PW and BLPW cabinets up to 15" deep may be mounted at ceiling height using standard installation procedures.
- PW and BLPW cabinets increased to more than 15" deep must be stacked or floor mounted.
- When mounting cabinet at ceiling height, the cabinet must be securely attached to the ceiling rafters and to at least one other properly mounted cabinet or studs in wall.
- Additional 2" x 4" bracing may be required above ceiling if cabinets are not located directly below a rafter.
- Mount cabinet to the ceiling using mounting screws of sufficient length to go through ceiling treatment and into the rafter at least 1". Screws must be installed at both front and back of cabinet on 16" centers (maximum span), with at least four screws per cabinet.

## Recessed Toe Kick Option

RTK

The Recessed Toe Kick Option is available on most Base, Desk and Vanity base cabinetry (refer to individual cabinet specifications for  verifying this option availability). When the Recessed Toe Kick Option is selected, left, right or both must be specified.

### Notes:

- Recommended for cabinets at the end of a run, especially in island and peninsula designs.
- Recessed side(s) are constructed of ½" thick unfinished plywood and are recessed 3½" to match front of cabinet.
- Recessed Toe Kick box is not flush on non-recessed side.
- Blind Corner Base cabinets (BLB\_) are only available with the Recessed Toe Kick Both Option (RTKB).
- BEA24 FH and BEA12 FH Base End Angle, BPP9 Base Pantry Pull Out, BPPUS9 Base Pantry Pull Out Utensil Storage, BTDP9 Base Tray Divider Pull Out, TB9 and TB9 TDS cabinets are not available with the Recessed Toe Kick Both Option (RTKB).
- Not available for cabinets with the Reduced Depth Option of RD-8 and lower.
- Not available for Peninsula Base cabinets with the Reduced Depth Option of RD-11 and lower.
- For Peninsula Base cabinets, the drawer side indicates the front of the cabinet.
- Peninsula Base cabinets ordered with Recessed Toe Kick Option must be secured to the floor through the cabinet bottom into bracing secured to the floor.
- Base Toe Kick (BTK8) required for front and any exposed side(s).

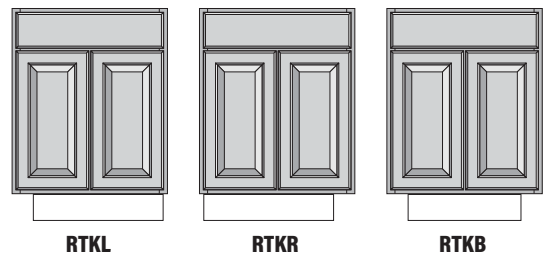

## CushionClose Package

The CushionClose package includes CushionClose for Drawers (including full-height pull outs), CushionClose for Doors and CushionClose for Roll Out Accessories and is pre-selected in 20-20.

### Notes:

- CushionClose for Drawers and CushionClose for Roll Out Accessories provide all of the features and benefits of the standard Full-Access Hidden Glides System with the addition of an integrated slow-close mechanism that reduces slamming and noise.
- CushionClose for Doors features a slow closing mechanism that helps reduce slams and noise.
- CushionClose Hinge features a toggle switch to allow for CushionClose mechanism to be turned off.
- Decorative hardware strongly recommended.
- CushionClose is not available for BER\_, BSDC6, BSS\_, CAR\_, MC\_, TV\_30, WER\_ and WTH\_.

## Remove CushionClose for Doors

**XCDO**

The Remove CushionClose for Doors option is available for most cabinets with a door.

### Notes:

- This option removes CushionClose for Doors.

## Remove CushionClose for Drawers

**XCDW**

The Remove CushionClose for Drawers option is available for all cabinets with a drawer.

### Notes:

- Removes CushionClose for Drawers and replaces glides with Full-Access Hidden Glides.
- Glides on the wastebasket pull out will be replaced with heavy-duty non-CushionClose glides.
- CushionClose cannot be removed from 2 Drawer Base cabinets.

## Remove CushionClose Roll Out Accessories

**XCRO**

The Remove CushionClose for Roll Out Accessories is available for most cabinets.

### Notes:

- This option removes CushionClose from Roll Out Accessories and replaces glides with side-mounted glides.

## Furniture Ends Option

FE

Furniture Ends Option includes:

- ¾" plywood cabinet sides

### Notes:

- Exterior sides feature plywood finished to match specific cabinet box exterior.
- Plywood will be visible from top and bottom of side panels.
- Available on individual cabinets except BEA24 FH Base End Angle and WEA12 Wall End Angle cabinets.
- Both side panels convert to ¾" plywood sides except BEA12 FH Base End Angle cabinet which converts the 12" side panel only.
- Available for all door styles.
- All door styles feature standard interior sides with a natural woodgrain look and matching exterior sides.
- Cannot be ordered with Plywood Ends Option.
- End panels are not required for installation of Decorator Matching Doors to cabinets with the Furniture Ends Option.
- Cabinet Angle Molding (CAM8) cannot be used with cabinets with the Furniture Ends Option.
- Sink Front Return (SFR R/L) with the Furniture Ends Option will include a rabbeted front edge.
- A seam will be visible between stacked cabinets and on 93" and 96" Tall cabinets between the toe kick box and the cabinet. Use decorative molding to conceal this seam.
- Plywood can consist of a combination of veneer and MDF layers to achieve superior product stability and finish quality. Plywood components meet the ANSI/Decorative Hardwoods Association hardwood and decorative plywood standards ([www.decorativehardwoodsassociation.org](http://www.decorativehardwoodsassociation.org)).

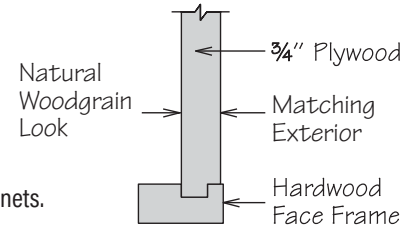

## Matching Interior Option

MI

The Matching Interior Option is available for Wall cabinets (with exceptions noted below), Utility cabinets, Vanity Linen cabinets and Refrigerator Return Panels. This option matches the cabinet's interior, top and bottom to that of the cabinet box exterior. For textured-wrapped Duraform, refer to door style page for box finish.

### Notes:

- Available for Wall, Utility and Vanity Linen cabinets with the All Plywood Construction Option (APC), Plywood Ends Option (PE), Furniture Ends Option (FE), Reduced Depth Option (RD), Increased Depth Option (ID) or standard construction.
- Shenandoah strongly recommends using the All Plywood Construction Option (APC) when Matching Interior (MI) is selected.
- Standard construction cabinetry with the Matching Interior Option features two-sided engineered wood side panels finished to match cabinet box exterior.
- Cabinetry with the All Plywood Construction Option (APC), Furniture Ends Option (FE) or Plywood Ends Option (PE) features plywood side panels finished to match cabinet box exterior.
- Matching Interior cabinetry with the All Plywood Construction Option features ¾w plywood shelves finished to match cabinet box exterior.
- Recommended for cabinets with the Void Door Option (VDO).
- Not available for any Wall cabinet with a standard Matching Interior (i.e. Specialty Door cabinets, Bookshelves, Microwave Cabinets, etc.).
- All finished surfaces of the Wall, Utility and Vanity Linen cabinets will be color matched including shelves, back, interior and exterior of returns, top and bottom, Corner Wall back post and back side of Peninsula Wall face frames.
- Interior accessories in Matching Interior cabinets (i.e., Spice Rack Kit, Deep Roll Out Trays, Pantry Swing Out Kit) will remain natural finish.

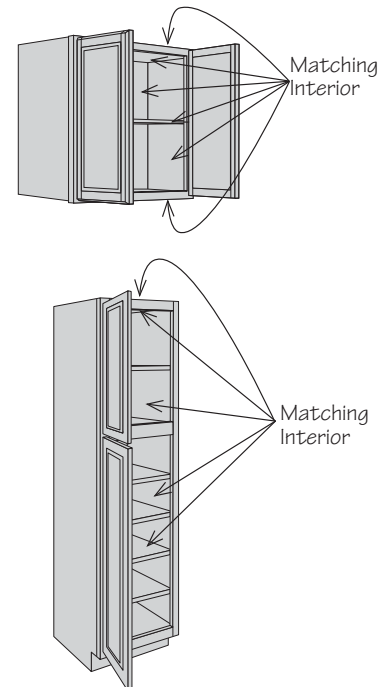

## Specialty Door Options

Specialty Door cabinets are available for most Wall, Utility and Vanity Linen cabinet sizes. All Specialty Door cabinets include Matching Interior as standard and require one of the specialty door options below. Specialty Door options for Utility and Vanity Linen cabinets apply to top door(s) only.

### **Open Frame Door (OFD) notes:**

- Features door frame only with no mullions or center panel.
- Decorative Glass Inserts and appropriate glass clips are shipped separately from the cabinet for field installation - see pages 64-65 for available Glass Inserts.
- See page 60 for door style profiles.

### **Mullion Frame Door (MFD) notes:**

- Features grid-style mullions.
- Not available for Wall Top Hinge cabinets.
- Decorative Glass Inserts and appropriate glass clips are shipped separately from the cabinet for field installation - see pages 64-65 for available Glass Inserts.
- See pages 61-62 for door style profiles.

### **Aluminum Frame Door (AFBA) notes:**

- Available for Full Overlay door styles only.
- Door stiles and rails are 2 1/8" mitered aluminum with Brushed Aluminum finish.
- Glass panels are factory installed and non-removable -see page 63 for glass combinations.
- Glass panels are tempered for safety with etched finish.

### Specialty Door Availability by Size

Door Width	Cabinet Door Height													
	12" High Wall	15" High Wall	18" High Wall	21" High Wall	24" High Wall	27" High Wall	30" High Wall	36" High Wall	39" High Wall	42" High Wall	84" High Utility or Vanity Linen	90" High Utility	93" High Utility	96" High Utility
12" Wide			●		●		●	●	●	●	●	●	●	●
13" Wide			●		●		●	●	●	●				
15" Wide	●	●	●	●	●	●	●	●	●	●	●	●	●	●
16" Wide	●	●	●	●	●		●	●	●	●				
18" Wide	●	●	●	●	●		●	●	●	●	●	●	●	●
19" Wide	●	●	●	●	●		●							
21" Wide			●		●		●	●	●	●				
30" Wide		■	■											
36" Wide		■	■											

- Available with all Specialty Door Options
- Wall Top Hinge cabinets only - not available with MFD

### Specialty Door Availability by Door Style

Door Style	OFD	MFD	AFBA
Audrey	●		
Breckenridge	●	●	●
Breckenridge Duraform	●		●
Breckenridge w/ DFO	●	●	●
Breckenridge w/ DFO Duraform	●		●
<b>Cardiff</b>	●		
Cardiff w/ DFO	●		
Cottage	●	●	●
Dominion	●	●	
Edgeworth	●	●	●
Edgeworth w/ DFO	●	●	●
<b>Glasson</b>	●	●	●
<b>Glasson w/ DFO</b>	●	●	●
<b>Irvington</b>	●	●	●
Irvington w/ DFO	●	●	●
<b>Irvington Duraform</b>	●		●
Irvington Duraform w/ DFO	●		●
McKinley	●	●	●
Mission	●	●	●
Mission w/ DFO	●	●	●
Mission w/ DFO Duraform	●		●
Stemson	●	●	●
Sydney	●		●
Warren	●		●
Warren w/ DFO	●		●

# Open Frame Specialty Doors

OFD

**Profiles for:**

- Dominion
- Edgeworth
- Edgeworth w/ DFO

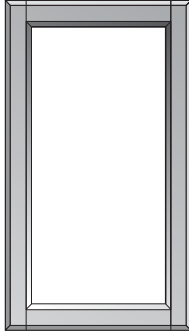

**Profiles for:**

- Stemson

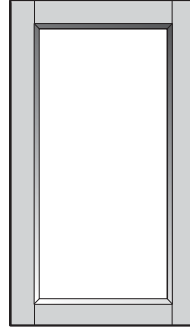

**Profile for:**

- Audrey
- Breckenridge
- Breckenridge w/ DFO
- Cottage
- Glasson
- Glasson w/ DFO

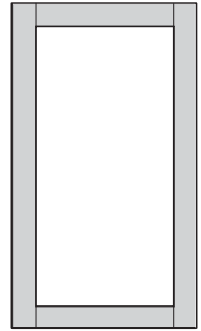

**Profile for:**

- Mission
- Mission w/ DFO
- Sydney

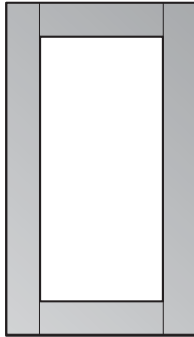

**Profile for:**

- Cardiff
- Cardiff w/ DFO

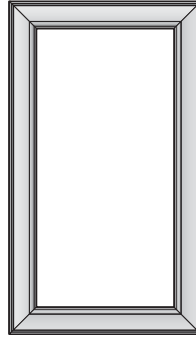

**Profile for:**

- Irvington
- Irvington w/ DFO

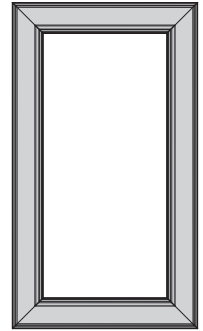

**Profile for:**

- McKinley

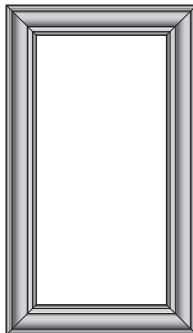

**Profile for:**

- Warren
- Warren w/ DFO

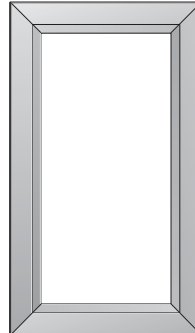

Mullion Frame Specialty Doors

MFD

Profiles for:

- Dominion
- Edgeworth
- Edgeworth w/ DFO

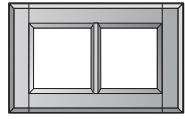

12" High Wall Cabinet

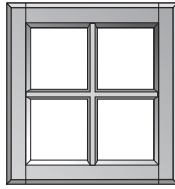

15", 18", 21", 24" or 27" High Wall Cabinet

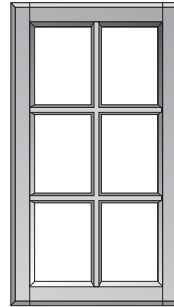

30" or 36" High Wall Cabinet  
84" or 90" High Utility Cabinet  
84" High Vanity Linen Cabinet

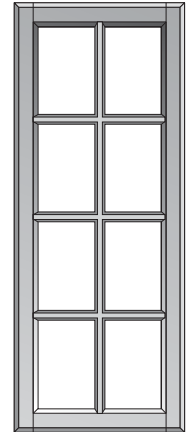

39" or 42" High Wall Cabinet  
93" or 96" High Utility Cabinet

Profile for:

- Stemson

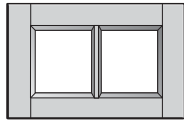

12" High Wall Cabinet

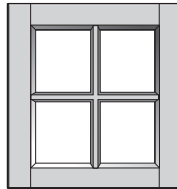

15", 18", 21", 24" or 27" High Wall Cabinet

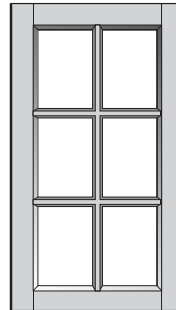

30" or 36" High Wall Cabinet  
84" or 90" High Utility Cabinet  
84" High Vanity Linen Cabinet

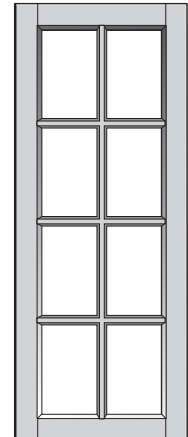

39" or 42" High Wall Cabinet  
93" or 96" High Utility Cabinet

Profile for:

- Breckenridge\*
- Breckenridge w/ DFO\*
- Cottage
- Glasson
- Glasson w/ DFO

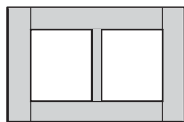

12" High Wall Cabinet

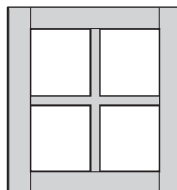

15", 18", 21", 24" or 27" High Wall Cabinet

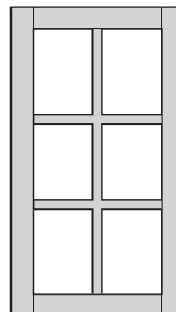

30" or 36" High Wall Cabinet  
84" or 90" High Utility Cabinet  
84" High Vanity Linen Cabinet

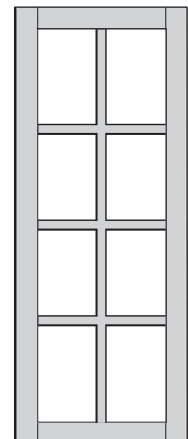

39" or 42" High Wall Cabinet  
93" or 96" High Utility Cabinet

\*Not available for Duraform

Mullion Frame Specialty Doors

MFD

Profile for:

- Mission
- Mission w/ DFO\*

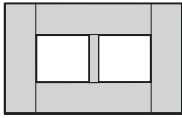

12" High Wall Cabinet

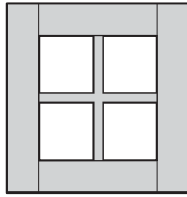

15", 18", 21", 24" or 27" High Wall Cabinet

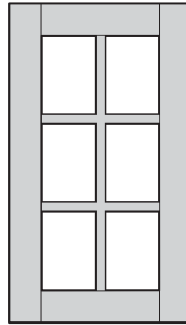

30" or 36" High Wall Cabinet  
84" or 90" High Utility Cabinet  
84" High Vanity Linen Cabinet

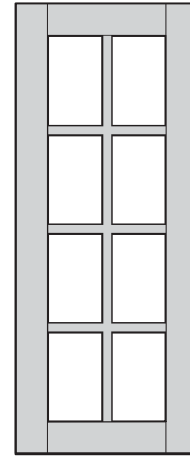

39" or 42" High Wall Cabinet  
93" or 96" High Utility Cabinet

\*Not available for Duraform

Profile for:

- McKinley

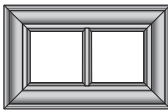

12" High Wall Cabinet

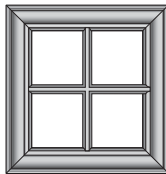

15", 18", 21", 24" or 27" High Wall Cabinet

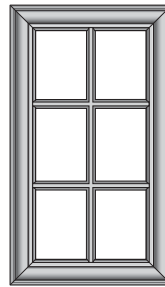

30" or 36" High Wall Cabinet  
84" or 90" High Utility Cabinet  
84" High Vanity Linen Cabinet



39" or 42" High Wall Cabinet  
93" or 96" High Utility Cabinet

Profile for:

- Irvington\*
- Irvington w/ DFO\*

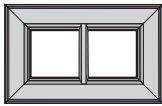

12" High Wall Cabinet

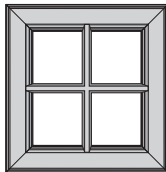

15", 18", 21", 24" or 27" High Wall Cabinet

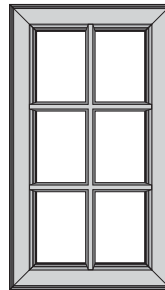

30" or 36" High Wall Cabinet  
84" or 90" High Utility Cabinet  
84" High Vanity Linen Cabinet

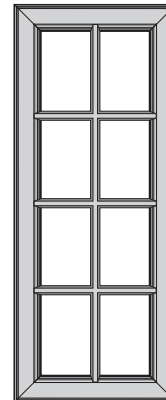

39" or 42" High Wall Cabinet  
93" or 96" High Utility Cabinet

\*Not available for Duraform



**Aluminum Frame Specialty Doors - Brushed Aluminum**

**AFBA**

**Profile for:**

- Breckenridge
- Breckenridge w/ DFO
- Cottage
- Edgeworth
- Edgeworth w/ DFO
- **Glasson**
- **Glasson w/ DFO**
- **Irvington**
- Irvington w/ DFO
- McKinley
- Mission
- Mission w/ DFO
- Stemson
- Sydney
- Warren
- Warren w/ DFO

Brushed Aluminum  
with Frosted Glass



AFBA Frosted

Brushed Aluminum  
with Frosted Ash Glass



AFBA Frosted Ash

CONSTRUCTION OPTIONS

**Clear Glass**



MFD
OFD

- ½" thick panel
- Clear glass
- Tempered safety glass
- Includes appropriate Decorative Glass Clips
- Order as DGI-\_\_CLEAR, refer to Parts Directory for nomenclature and dimensions

**Derbyshire Seeded Glass**



MFD
OFD

- ⅝" thick panel
- Clear seeded glass
- Laminated safety glass
- Includes appropriate Decorative Glass Clips
- Order as DGI-\_\_DERBYSHIRE, refer to Parts Directory for nomenclature and dimensions

**Frosted Glass**



MFD
OFD

- ½" thick panel
- Frosted glass with etched finish
- Tempered safety glass
- Includes appropriate Decorative Glass Clips
- Order as DGI-\_\_FROSTED, refer to Parts Directory for nomenclature and dimensions

**Frosted Ash Glass**



MFD
OFD

- ½" thick panel
- Gray tinted glass
- Tint is manufactured in material - not a film
- Tempered safety glass
- Includes appropriate Decorative Glass Clips
- Order as DGI-\_\_FROSTED ASH, refer to Parts Directory for nomenclature and dimensions

**Impression Glass**



MFD
OFD

- ½" thick panel
- Sculptural glass
- Tempered safety glass
- Includes appropriate Decorative Glass Clips
- Order as DGI-\_\_IMPRESSION, refer to Parts Directory for nomenclature and dimensions

**Meredith Glass**



MFD
OFD

- ¼" overall thickness (⅛" beveled edge thickness)
- Clear glass design with 1 ¼" wide beveled edges
- Tempered safety glass
- Includes appropriate Decorative Glass Clips
- Order as DGI-\_\_MEREDITH, refer to Parts Directory for nomenclature and dimensions

**Ribbed Glass**



MFD  
OFD

- 1/8" thick panel
- Clear ribbed glass
- Tempered safety glass
- Includes appropriate Decorative Glass Clips
- Not available for Wall Top Hinge cabinets
- Order as DGI-\_\_RIBBED, refer to Parts Directory for nomenclature and dimensions

**Prepped for Glass**

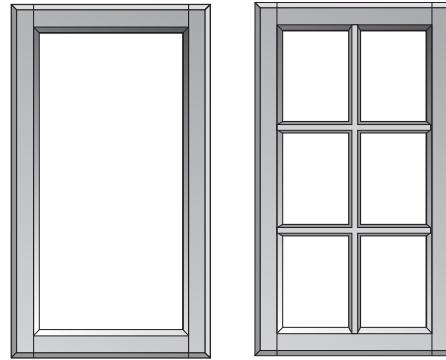

MFD  
OFD

- For customer installed inserts up to 5/16" thick
- Refer to pages 60-62 for door style specific profile
- Decorative Glass Clips not included - order separately

**Decorative Glass Clips**

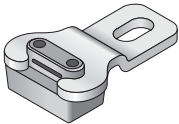

CLIP DGI 1/8

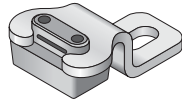

CLIP DGI 5/16

Glass Insert	CLIP DGI 1/8	CLIP DGI 5/16
Clear	•	
Derbyshire		•
Frosted	•	
Frosted Ash	•	
Impression	•	
Meredith	•	
Ribbed	•	

CLIP DGI 1/8  
CLIP DGI 5/16

- For installation of Decorative Glass Inserts
- Order one bag (six clips) per door
- See chart for correct glass pairing

